

REV.	DATE	ECO	DESCRIPTION	BY	CK	APP
-	8/16/2004	N/A	INITIAL RELEASE	LAS	N/A	N/A
B	1/24/2024	18032	REDRAWN FROM CADRA, UPDATED TITLE BLOCK, ADDED NOTES, DIM .44[11.2] WAS .50[12.7], 1 LBS FORCE WAS 2 LBS FORCE	YF	N/A	SEE ECO

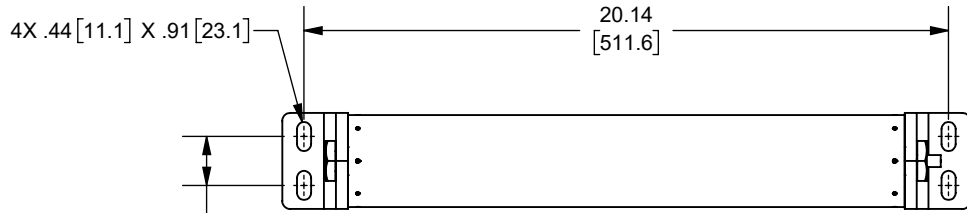

1.53
[38.8]

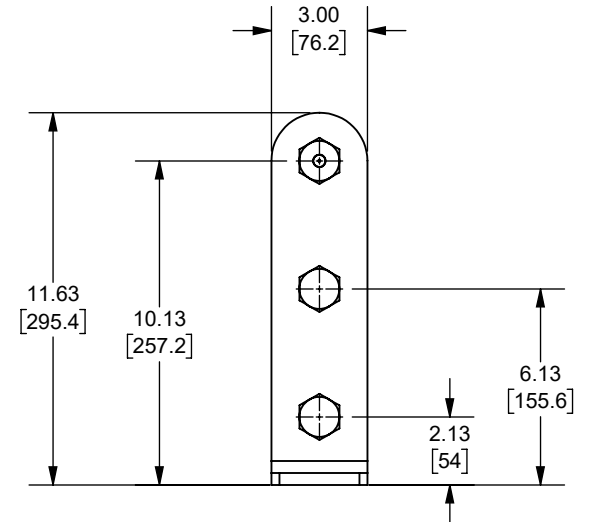
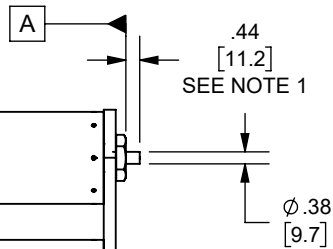

.38
[9.5]

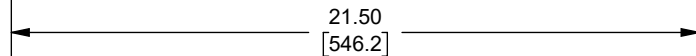

OUTLINE DIMENSIONS
NOT TO BE USED FOR PRODUCTION

DIMENSIONS IN []
ARE MILLIMETERS

NOTES:

1. INDICATOR IS FLUSH WITH SURFACE **A** BEFORE FUSE OPENS INDICATOR EXTENDS .44 IN. [11.2mm] AFTER FUSE OPENS AND EXERTS AN 1 LBF AT THE END OF TRAVEL.

Approval stage / Etat d'approbation: APPROUVÉ POUR FABRICATION / APPROVED FOR MANUFACTURING		Product Class:/ Product Type: MEDIUM VOLTAGE BOLT- IN SERIES	
Product amp rating:/ Voltage rating: 48X-57X 7.2kV MAX.		Title / Titre: OUTLINE	
Initial ECO / ECO intiale: ECO-18032-000		Weight : Masse :	
Draw by / Dessiné par: Yadyra Fang	Date : 6/14/2024	Drawing / de dessin: 701080	
Checked by / Vérifié par: Luis ARMENTA	Date : 6/14/2024	Rev : B	
Electrical Power 374 MERRIMAC STREET NEWBURYPORT, MA 01950	Éch / Scale : 1:6 Format / Size : A	Part / Article: SEE TABLE	Page : 1/1

A072B3DBR0-57X
A072B3DBR0-48X
CATALOG
NUMBER



Ce plan strictement confidentiel est la propriété exclusive de la société MERSEN sans l'autorisation écrite de laquelle il ne peut être ni reproduit, ni copié, ni communiqué à des tiers.
This drawing and specifications there on is property of MERSEN and shall not be reproduced or copied or used in whole or in part as the base for manufacture or sale of item without written permission.