

REV	DATE	ECO	DESCRIPTION	BY	CK	APP
-	1/29/02	N/A	INITIAL RELEASE	LAS	N/A	N/A

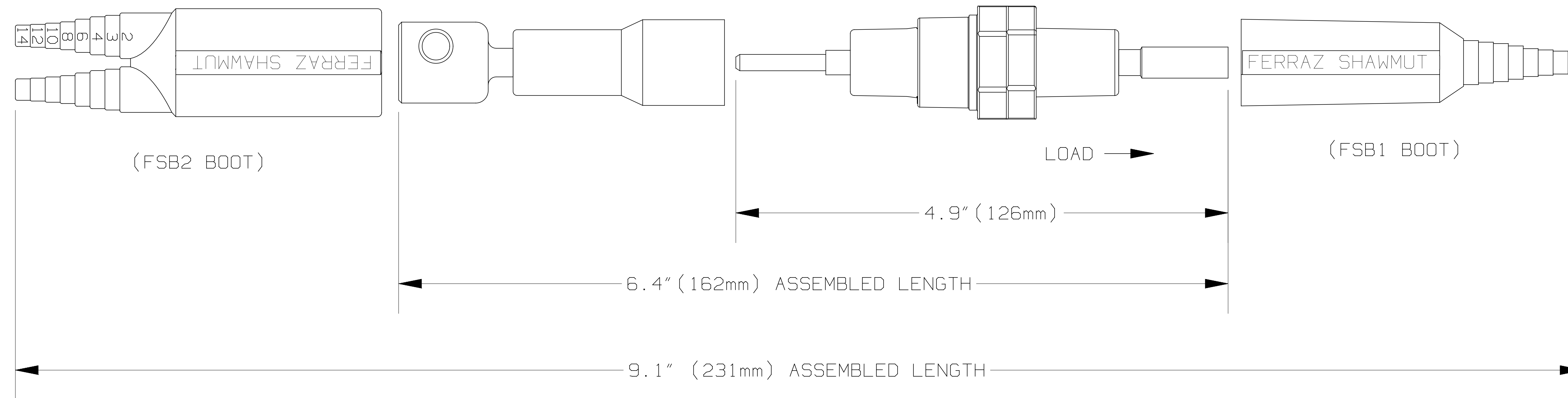

P/N	AMPERE RATING	RMS SYM RATING	CONN TYPE	TORQUE (LBS-IN)	WIRE			UL		CSA	
					WIRE RANGE	°C	TYPE	FILE NO.	GUIDE NO.	FILE NO.	CLASS
FEB-21-91-BA	30	100,000	21-Cu CRIMP	-	{1} #4 SOL {1} #6 SOL/STR {2} #10 SOL/STR	75	Cu	E52283	IZLT2	32169	6225
			91-Cu DOUBLE SET SCREW	50 35 25 20	{1} #2-3 SOL/STR {1} #4-6 SOL/STR {1} #8 SOL/STR {1} #10-12 SOL/STR						

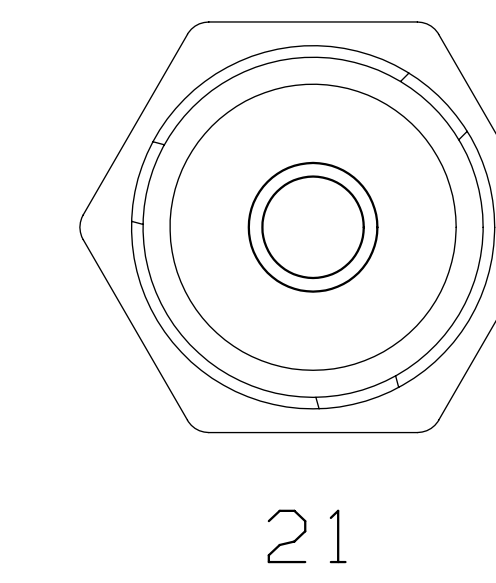
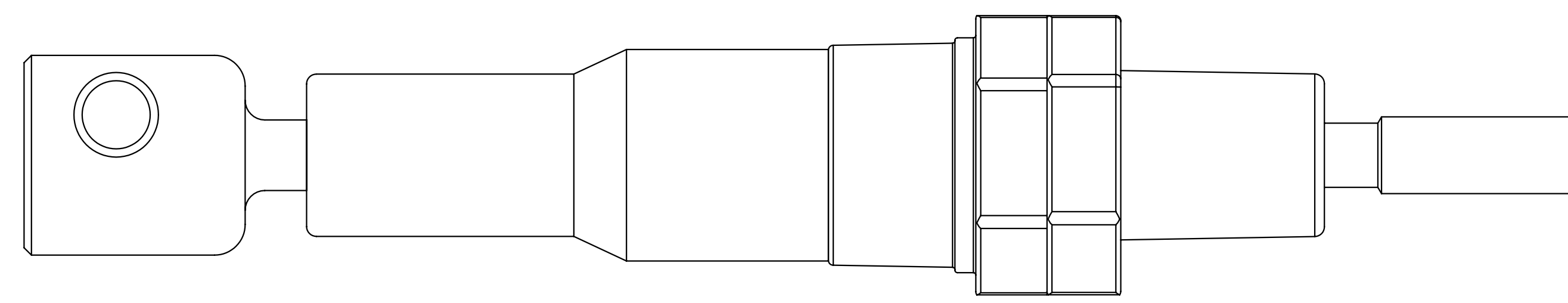
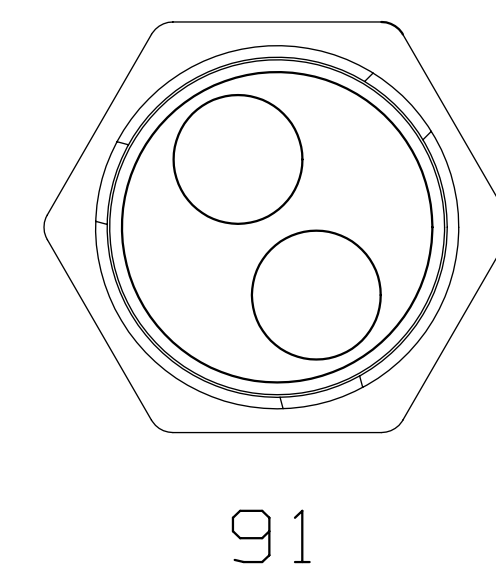

MERSEN USA NEWBURYPORT-MA, LLC
374 MERRIMAC STREET
NEWBURYPORT, MA 01950

FUSE HOLDER, 600V-30A,
1 POLE, IN-LINE,
MIDGET
BREAKAWAY CONFIGURATION

OUTLINE DIMENSIONS
NOT TO BE USED FOR PRODUCTION

700704

PRODUCT MANAGER	DESIGN ENGINEER
SIGN:	SIGN:
DATE:	DATE: