

REV.	DATE	ECO	DESCRIPTION	BY	CK	APP
B	5/1/2018	N/A	ADDED TOLERANCES TO ALL DIM.'S, DIM 3.321 WAS 3.34, DIM Ø.427 WAS .45, DIM 2.38 REPLACED BY DIM.'S .480 SCHEME	MAR	N/A	N/A
C	10/20/2022	16923	UPDATED FORMAT	PG	YF	SEE ECO

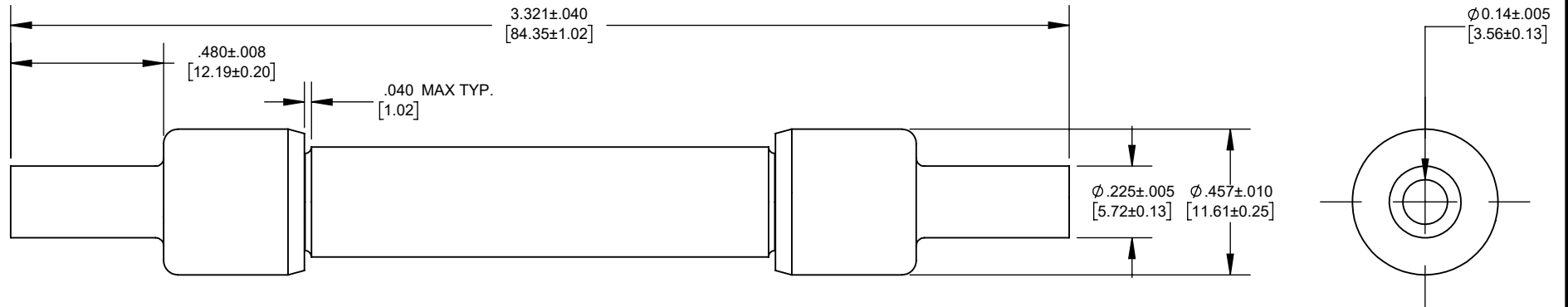

OUTLINE DIMENSIONS
NOT TO BE USED FOR PRODUCTION
DIMENSIONS IN [] ARE MILLIMETERS

Approval stage / Etat d'approbation:		Product Class:/ Product Type: PV FUSE		Weight : g Masse : 9	
Initial ECO / ECO initiale:		Product amp rating:/ Voltage rating: 2 1/2 - 5A 1500VDC		Title / Titre: HP15G(2 1/2 -5)CC	
Draw by / Dessiné par:	Date :	Drawing / de dessin: 702161			
Checked by / Vérifié par:	Date :	Part / Article: 242045		Page : 1/1	
Electrical Power 374 MERRIMAC STREET NEWBURYPORT, MA 01950		Éch / Scale : 2:1 Format / Size : A		MERSEN	
Ce plan strictement confidentiel est la propriété exclusive de la société MERSEN sans l'autorisation écrite de laquelle il ne peut être ni reproduit, ni copié, ni communiqué à des tiers. This drawing and specifications there on is property of MERSEN and shall not be reproduced or copied or used in whole or in part as the base for manufacture or sale of item without written permission.					